

32ft open plan office

## STEEL CABIN RANGE FOR HIRE AND SALE

# Office and meeting space

A range of solutions for temporary and long-term office and meeting facilities are on offer to suit different requirements, all with superior specification.



20ft open plan office

### Steel cabins

Available in 12ft, 16ft, 20ft, 24ft, 32ft and 40ft lengths, units are clean and create a good working environment to accommodate desks, meeting tables or a combination, depending on your individual requirements.

Only one electrical connection is needed to provide power for lighting, convection heaters and additional power sockets in the cabin.

Units of the same size can be stacked on the top or bottom of other cabins from the Steel Cabin range – for use as a canteen or drying room – and also on top of the stackable Steel Storage Containers. When stacked, the top unit is accessed via a steel staircase fitted on site by our trained and experienced delivery team. There's also a single staircase with double exit landing which can be used to access two blocks of stacked units.



Meeting room with canteen facilities

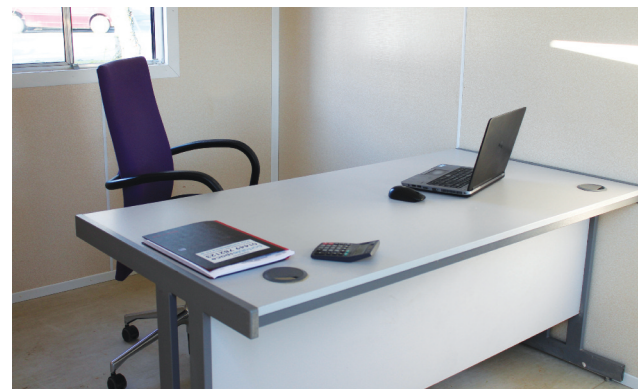

Typical office furniture

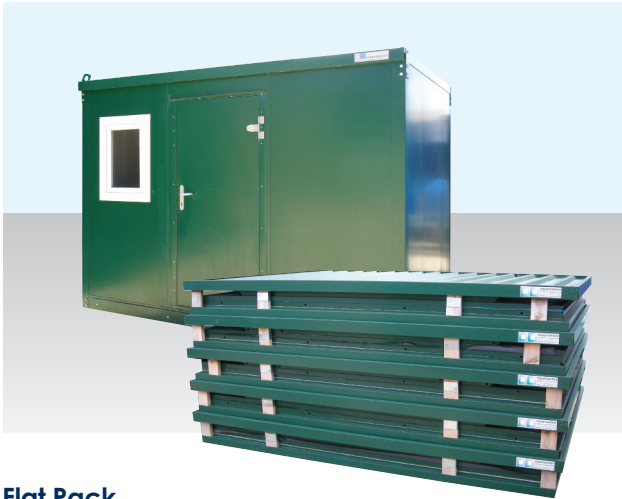

## Flat Pack

On some sites it is not possible or safe to deliver pre-fabricated buildings by lorry-mounted crane because of weak or low bridges, overhead obstructions such as electricity cables, or because of restricted site entrances and access.

The Flat Pack range is a practical alternative for office and meeting space on construction sites, as a home office or for a wide range of business uses from start-up companies through to multinationals.



Stack of five flat pack units and erected office (left)  
Interior view – flat pack office (above)

The units are made up from sections which are light enough to be offloaded from a flat bed pick-up and compact to fit through small passageways. Furniture packs are available for hire or sale, as required.

Recent large projects for flat pack accommodation have included erection inside multi storey car parks for building contractor project and welfare facilities, and on station platforms as part of temporary accommodation for infrastructure projects.



Static welfare



Static welfare canteen facilities

## Self-contained and towable office facilities

For sites where there is no mains power or water supply, Portable Space can offer units which incorporate their own generator, water and waste. These are available as both static units with a separate office area from the canteen facilities and delivered by lorry, or towable mobile units which can be used either as a project office or canteen and delivered by four-wheel drive vehicles.

All self-contained units have 12-volt LED lighting and diesel heaters which require less than two hours' engine use per day. Not only does this save fuel but also reduces noise and emissions in residential or work areas.

For sites with mains power but limited access, we also stock 16' and 20' mains-connected site towable mobile units which are more cost-effective in terms of weekly rental than the fully self-contained units.



Towable mobile unit

**STEEL OFFICE UNITS** CAD drawing examples below show 12' x 8', 24' x 9' and 32' x 10' office units

**OFFICE UNIT SIZE KEY**

- 12' x 8'
- 16' x 9'
- 20' x 8'
- 24' x 9'
- 32' x 10'

- DISTRIBUTION BOARD
- CONVECTOR HEATER
- TUBULAR HEATER
- HIGH LEVEL FAN HEATER
- RED BULKHEAD 16W PLS
- FLUORESCENT LIGHT
- BULKHEAD LIGHT
- WATER HEATER
- 13A TWIN SOCKET - LOW
- 13A TWIN SOCKET - HIGH
- SWITCH SPUR
- WALL LIGHT SWITCH
- PULL LIGHT SWITCH
- THERMOSTAT
- EXTRACTION FAN
- SHOWER HEATER
- FROST STAT
- VENT
- E.S. 12mm EARTHING STUD

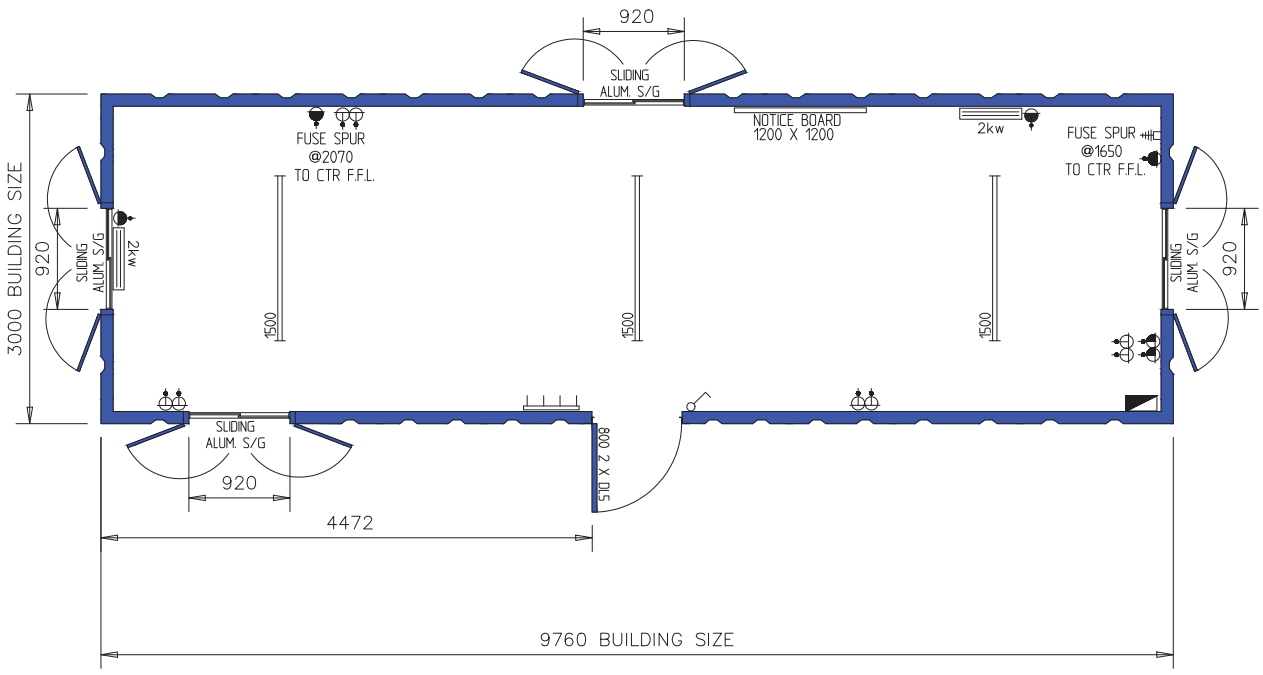
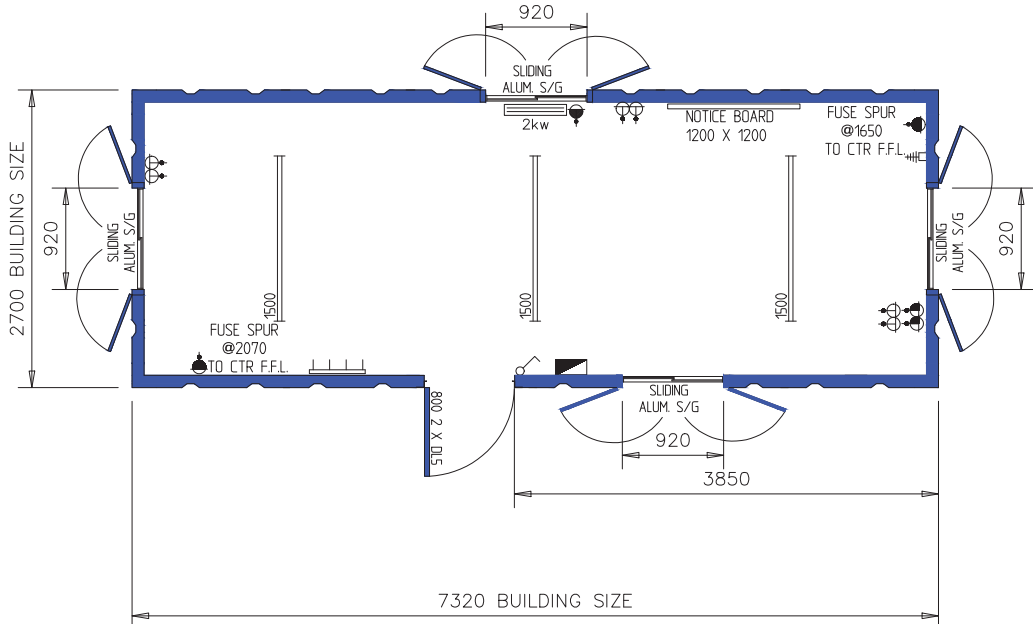
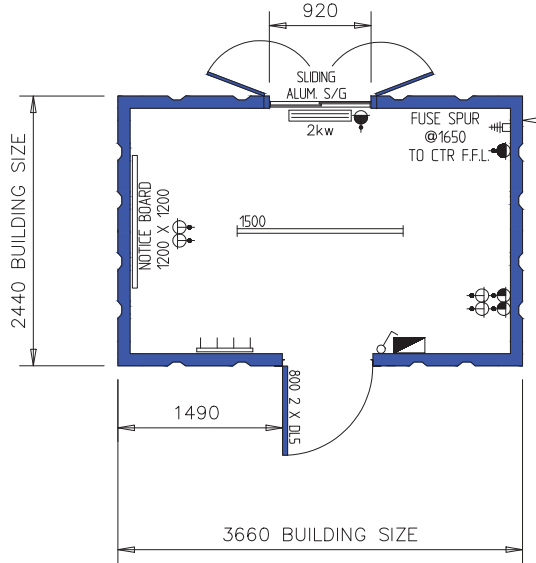

**STEEL OFFICE UNITS** CAD drawing examples below show 12' x 8', 24' x 9' and 32' x 10' office canteen units

**OFFICE UNIT SIZE KEY**

- 12' x 8'
- 16' x 9'
- 20' x 8'
- 24' x 9'
- 32' x 10'

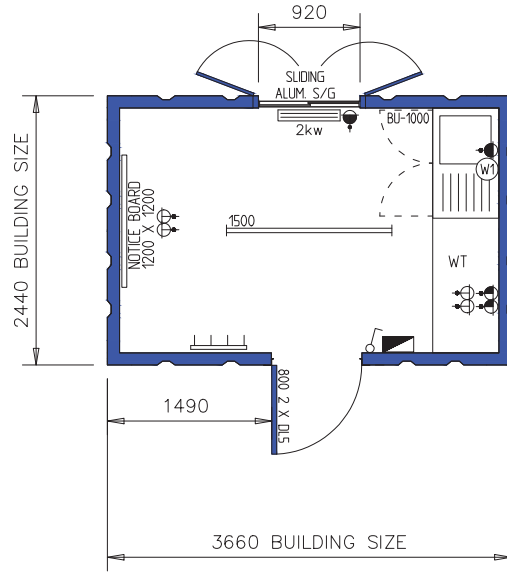

- DISTRIBUTION BOARD
- CONVECTOR HEATER
- TUBULAR HEATER
- HIGH LEVEL FAN HEATER
- RED BULKHEAD 16W PLS
- FLUORESCENT LIGHT
- BULKHEAD LIGHT
- WATER HEATER
- 13A TWIN SOCKET - LOW
- 13A TWIN SOCKET - HIGH
- SWITCH SPUR
- WALL LIGHT SWITCH
- PULL LIGHT SWITCH
- THERMOSTAT
- EXTRACTION FAN
- SHOWER HEATER
- FROST STAT
- VENT
- E.S 12mm EARTHING STUD

