

NOTES

1. THIS UNIT IS BASED ON OUR STANDARD PRODUCT SPECIFICATION
2. DRAWING SHOULD BE READ IN CONJUNCTION WITH CURRENT VERSION OF THE DRAWING LEGEND.
3. JACK LEG BRACKETS CANNOT BE FITTED DUE TO SIZE OF UNIT.
4. STAIRCASE BRACKET NOT FITTED

USE DIMENSIONS - DO NOT SCALE		
Dimension Units ALL IN MILLIMETRES		
COLOUR	BLUE (RAL 5013)	
FOUNDATION	015587-F1	
UNLADEN WEIGHT (KG)	1500	
MAXIMUM LADEN WEIGHT (KG)	2500	
MAXIMUM LIFT WEIGHT (KG)	2500	
Title 6' X 8' STEEL GATEHOUSE UNIT		
Product Code		
Date 17/09/19	Scale 1 : 40	Drawn By RMC
Drawing / Unit No. 45177		Rev. -

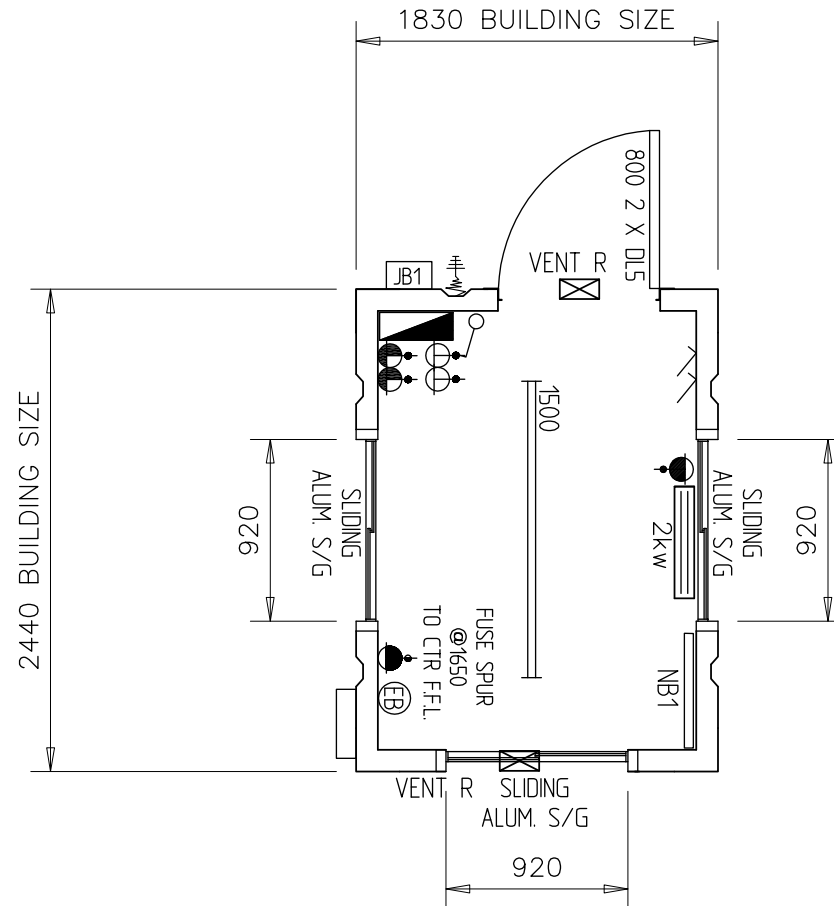

NOTES

1. THIS UNIT IS BASED ON OUR STANDARD PRODUCT SPECIFICATION
2. DRAWING SHOULD BE READ IN CONJUNCTION WITH CURRENT VERSION OF THE DRAWING LEGEND.
3. JACK LEG BRACKETS CANNOT BE FITTED DUE TO SIZE OF UNIT.
4. STAIRCASE BRACKET NOT FITTED

USE DIMENSIONS - DO NOT SCALE		
Dimension Units ALL IN MILLIMETRES		
COLOUR	BLUE (RAL 5013)	
FOUNDATION	015587-F1	
UNLADEN WEIGHT (KG)	1500	
MAXIMUM LADEN WEIGHT (KG)	2500	
MAXIMUM LIFT WEIGHT (KG)	2500	
Title 6' X 8' STEEL GATEHOUSE UNIT		
Product Code		
Date 17/09/19	Scale 1 : 40	Drawn By RMC
Drawing / Unit No. 45178		Rev. -

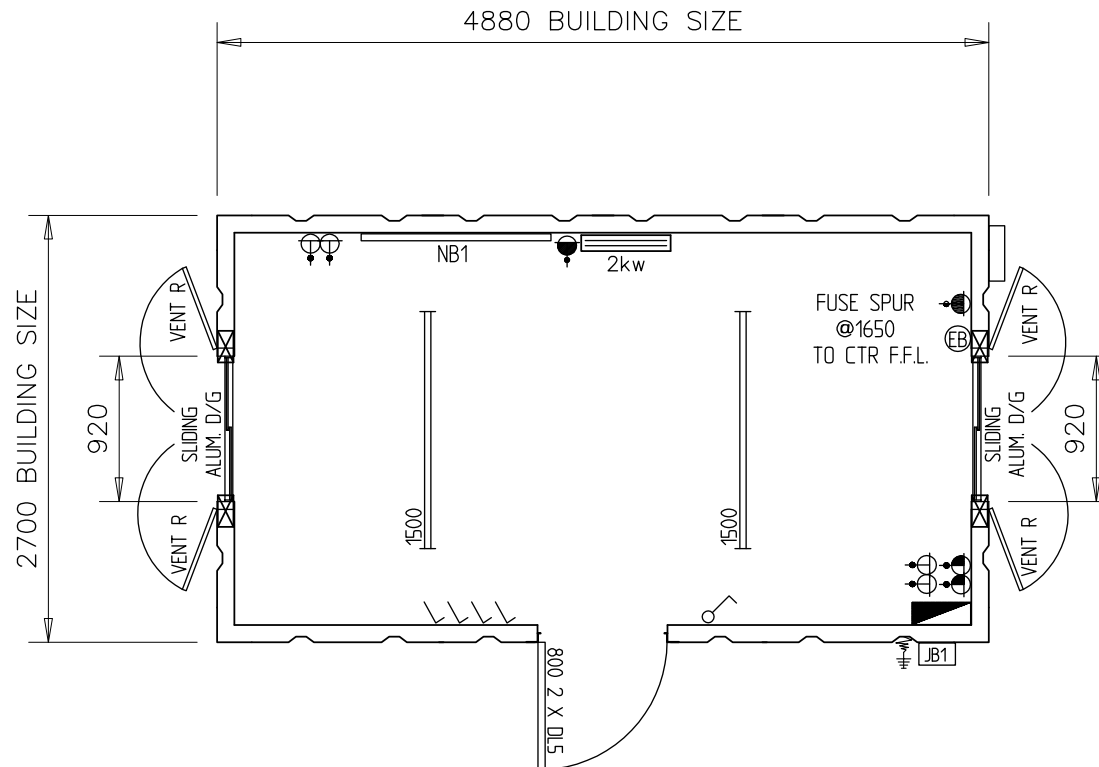

NOTES

1. THIS UNIT IS BASED ON OUR STANDARD PRODUCT SPECIFICATION
2. DRAWING SHOULD BE READ IN CONJUNCTION WITH CURRENT VERSION OF THE DRAWING LEGEND.

USE DIMENSIONS - DO NOT SCALE		
Dimension Units ALL IN MILLIMETRES		
COLOUR	BLUE (RAL 5013)	
FOUNDATION	015587-F2	
UNLADEN WEIGHT (KG)	2400	
MAXIMUM LADEN WEIGHT (KG)	4875	
MAXIMUM LIFT WEIGHT (KG)	4875	
Title 16' X 9' STEEL OFFICE UNIT		
Product Code -		
Date 17/09/19	Scale 1 : 50	Drawn By RMC
Drawing / Unit No. 45179		Rev. -

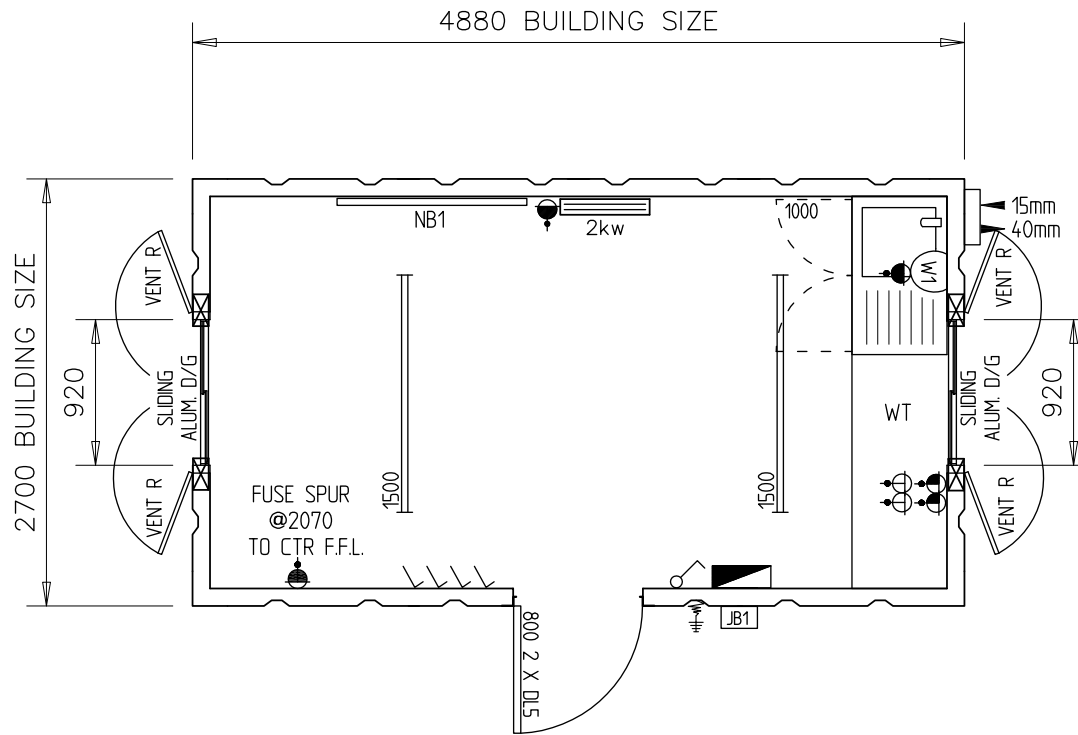

USE DIMENSIONS - DO NOT SCALE		
Dimension Units ALL IN MILLIMETRES		
COLOUR	BLUE (RAL 5013)	
FOUNDATION	015587-F2	
UNLADEN WEIGHT (KG)	2450	
MAXIMUM LADEN WEIGHT (KG)	4925	
MAXIMUM LIFT WEIGHT (KG)	4925	
Title 16' X 9' STEEL CANTEEN UNIT		
Product Code		
Date 17/09/19	Scale 1 : 50	Drawn By RMC
Drawing / Unit No. 45180		Rev. -

NOTES

1. THIS UNIT IS BASED ON OUR STANDARD PRODUCT SPECIFICATION.
2. DRAWING SHOULD BE READ IN CONJUNCTION WITH CURRENT VERSION OF THE DRAWING LEGEND.

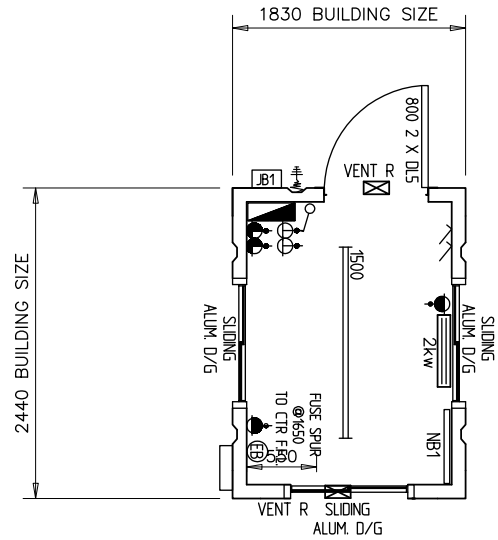

45177

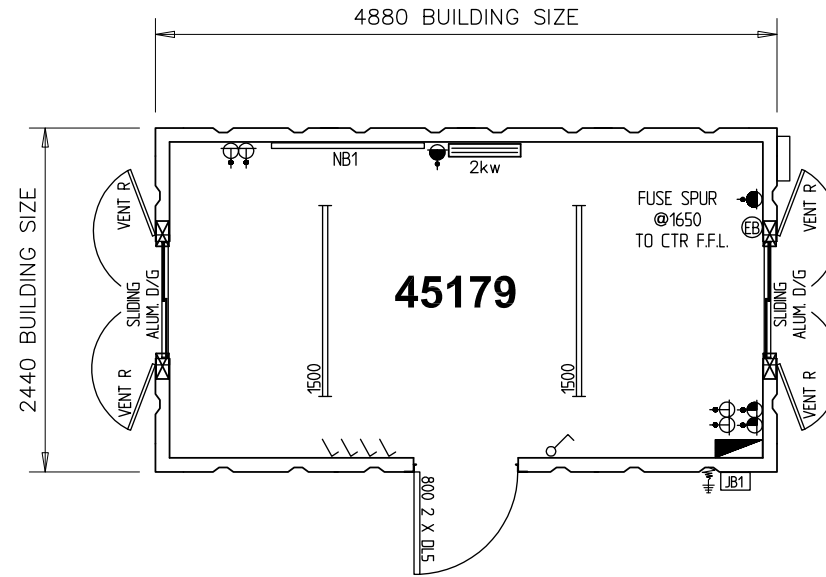

45179

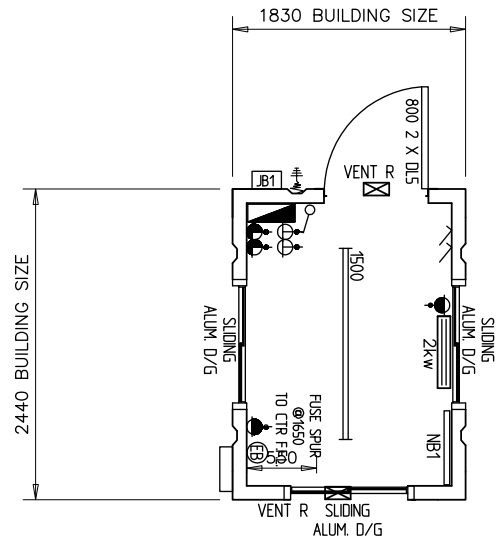

45178

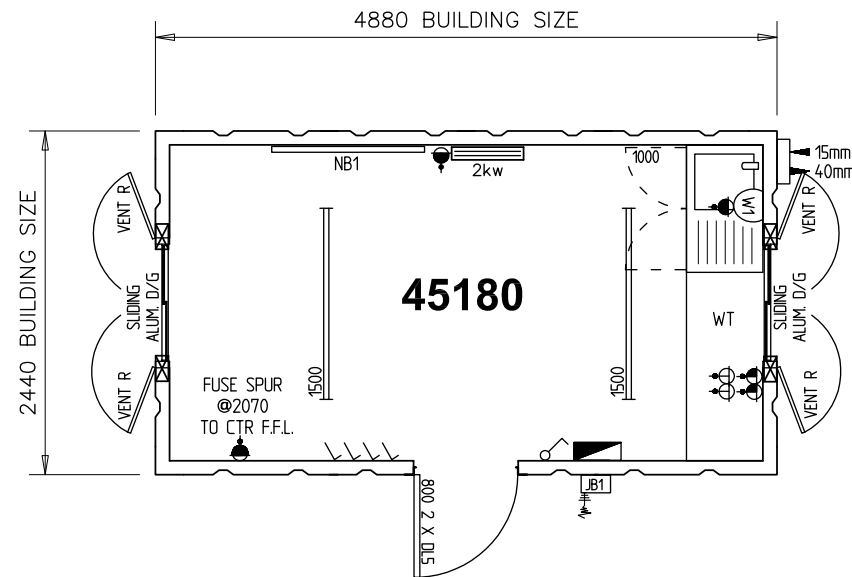

45180

NOTES

- THIS SITE PLAN DRAWING IS INTENDED TO PROVIDE A GENERAL SUMMARY OF THE PROJECT.
- THE INDICATED POSITIONS OF THE UNITS AND ANCILLARY ITEMS ARE FOR ILLUSTRATIVE PURPOSES ONLY.
- FULL SPECIFICATION AND CONFIGURATION DETAILS ARE PROVIDED ON THE INDIVIDUAL UNIT AND ANCILLARY ITEM DRAWINGS, AS REFERENCED.

USE DIMENSIONS - DO NOT SCALE

Dimension Units
ALL IN MILLIMETRES

Title
GENERAL PROJECT SUMMARY

Product Code _

REV.	DATE	BY	DESCRIPTION	Date	Scale	Drawn By
C	17/09/19	RMC	PROCEEDING TO PROJECT STAGE	12/09/19	NTS	DG
B	17/09/19	RMC	UNIT 1 AMENDED			
A	17/09/19	RMC	UNIT 1 AMENDED			
Drawing / Unit No. 015587-SP1				Rev. C		

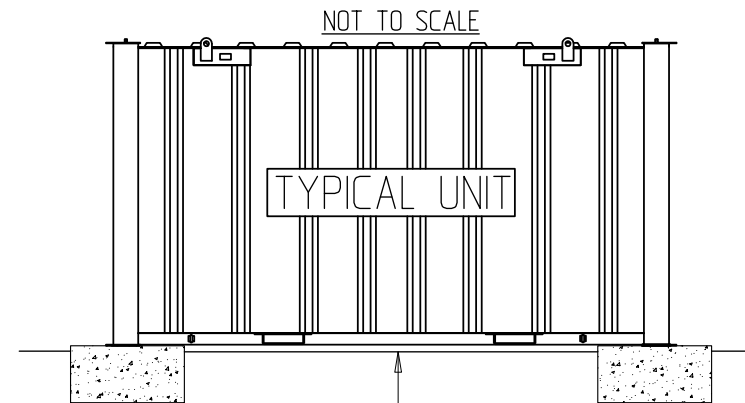
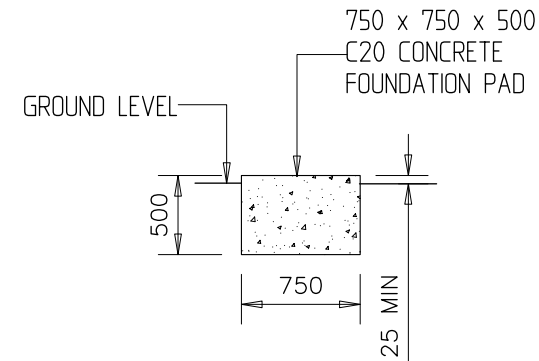
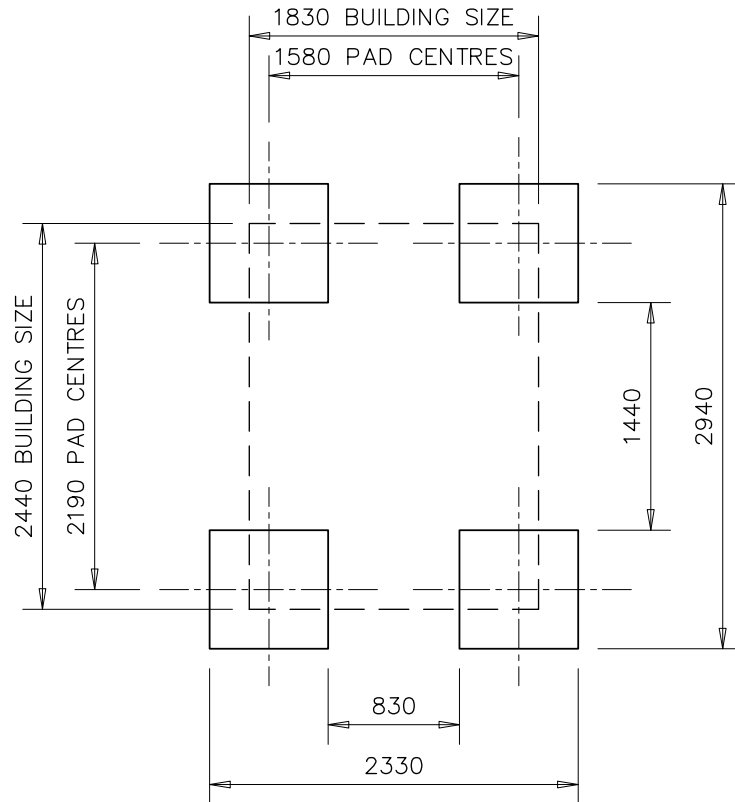

THE GROUND LEVEL IN THE AREA BETWEEN & ADJACENT TO THE PADS MUST NOT BE HIGHER THAN THE FINISHED LEVEL OF THE PADS THEMSELVES BECAUSE IT WILL OBSTRUCT THE POSITIONING OF THE UNIT

NOTES

1. THIS DESIGN IS SUITABLE ONLY FOR THE SIZE OF UNIT REFERENCED IN THE DRAWING TITLE IN A 1 STOREY CONFIGURATION.
2. ALTERNATIVE DESIGNS ARE AVAILABLE FOR 2 AND 3 STOREY CONFIGURATIONS AND OTHER PRODUCT SIZES.
3. FOUNDATION DESIGN IS FOR A LEVEL SITE WITH A GROUND BEARING CAPACITY OF 110 KN/M SQ. AND A BUILDING FLOOR LOADING OF 3 KN/M SQ.
4. DEPTH OF FOUNDATIONS IS DEPENDENT ON LEVEL OF GROUND BEARING STRATA ON SITE OR AS REQUIRED BY LOCAL AUTHORITY.
A MINIMUM DEPTH OF 500mm IS REQUIRED TO JUSTIFY THE LOAD PRESSURE.

USE DIMENSIONS - DO NOT SCALE		
Dimension Units ALL IN MILLIMETRES		
Title FOUNDATION LAYOUT 6' X 8' - TYPE 1 1 STOREY CONFIGURATION		
Date 16/09/19	Scale 1 : 50	Drawn By RMC
Drawing / Unit No. 015587-F1		Rev. -

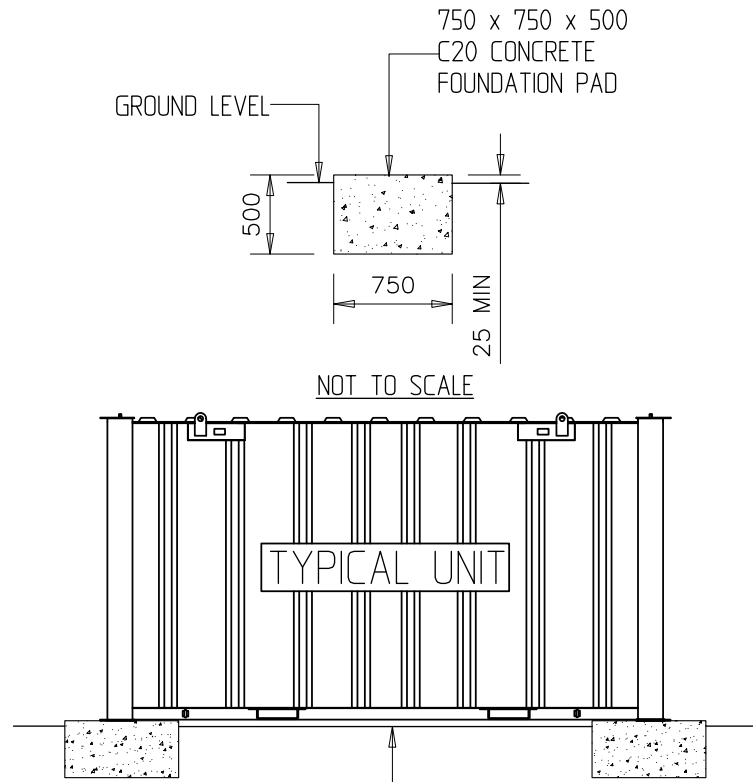
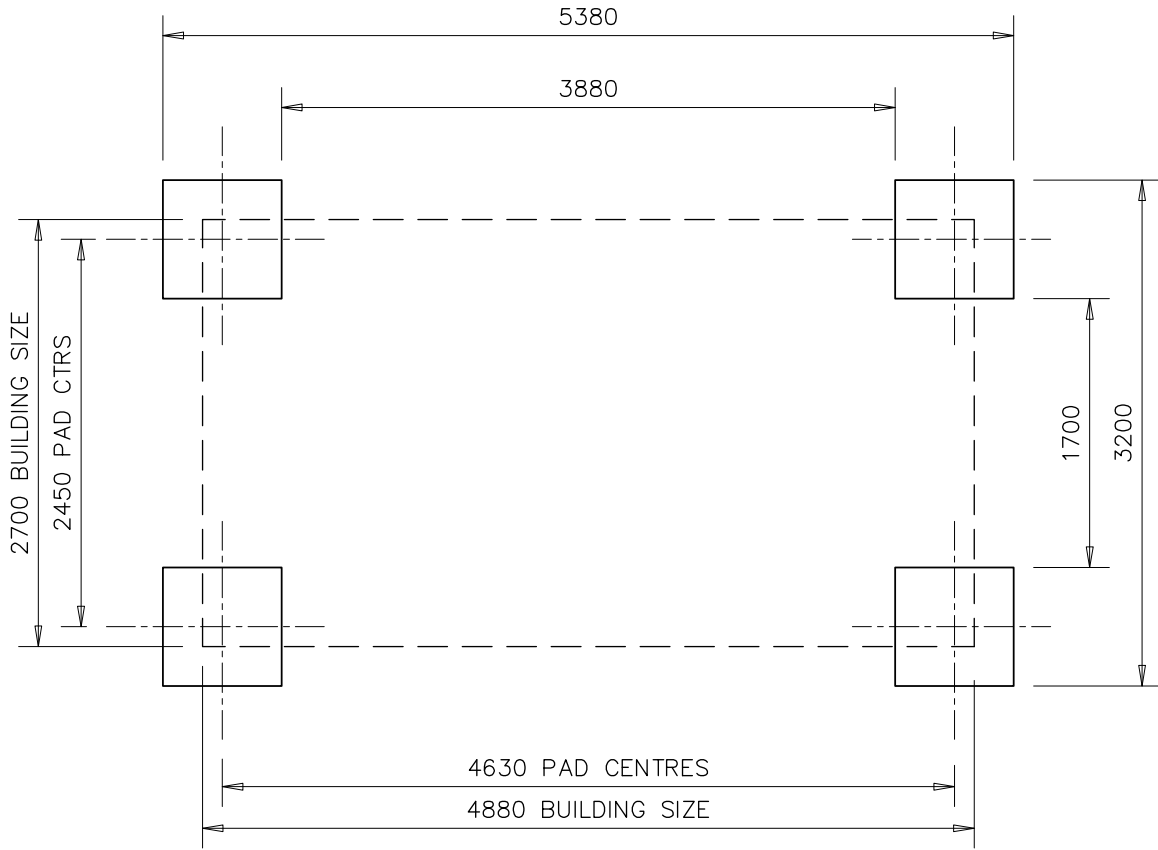

THE GROUND LEVEL IN THE AREA BETWEEN & ADJACENT TO THE PADS MUST NOT BE HIGHER THAN THE FINISHED LEVEL OF THE PADS THEMSELVES BECAUSE IT WILL OBSTRUCT THE POSITIONING OF THE UNIT

NOTES

1. THIS DESIGN IS SUITABLE ONLY FOR THE SIZE OF UNIT REFERENCED IN THE DRAWING TITLE IN A 1 STOREY CONFIGURATION.
2. ALTERNATIVE DESIGNS ARE AVAILABLE FOR 2 AND 3 STOREY CONFIGURATIONS AND OTHER PRODUCT SIZES.
3. FOUNDATION DESIGN IS FOR A LEVEL SITE WITH A GROUND BEARING CAPACITY OF 110 KN/M SQ. AND A BUILDING FLOOR LOADING OF 3 KN/M SQ.
4. DEPTH OF FOUNDATIONS IS DEPENDENT ON LEVEL OF GROUND BEARING STRATA ON SITE OR AS REQUIRED BY LOCAL AUTHORITY.
A MINIMUM DEPTH OF 500mm IS REQUIRED TO JUSTIFY THE LOAD PRESSURE.

USE DIMENSIONS - DO NOT SCALE		
Dimension Units ALL IN MILLIMETRES		
Title FOUNDATION LAYOUT 16' X 9' - TYPE 1 1 STOREY CONFIGURATION		
Date 17/09/19	Scale 1 : 50	Drawn By RMC
Drawing / Unit No. 015587-F2		Rev. -